

# AIOTION for Wirope

## MFL(Magnetic Flux Leakage) sensor principle

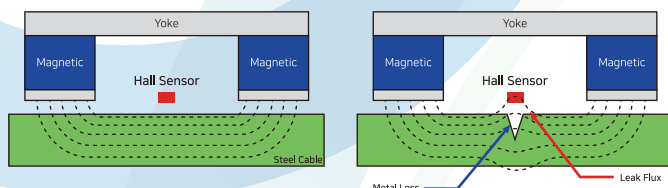

Measures magnetic flux leakage to damaged area

## MFL signal classification

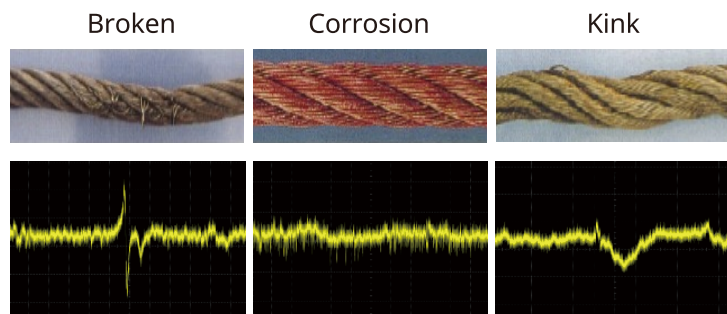

## Separated Sensor Module

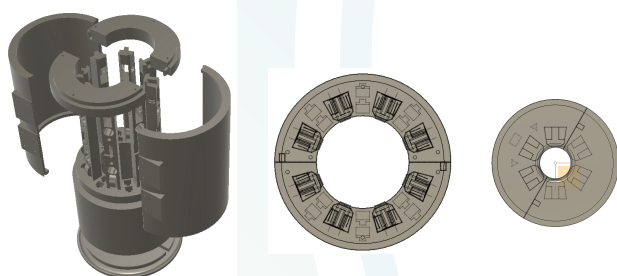

Applied to ropes of various thickness

## Easy installation



Battery type & Mount directly on the lower sheave (Patent : 10-2019-0037919)

## Competitive advantage

### 01 : Minimize installation

- Wire rope direct mounting type (Bolting & welding not required)
- Sensor is battery powered, so no electrical work

### 02 : Wire rope optimization

- Adaptable to various rope movements. (Patent item)
- Applicable to all wire ropes with lifting device. (Patent item)

### 03 : Non-stop safety diagnosis

- Safety diagnosis during crane operating
- Continuous real-time 365 days diagnosis
- There is no need to stop operation for crane safety diagnosis.

### 04 : Entire wire rope safety status can be monitored in real time

- The way to manage with one console per equipment is difficult to management as whole
- Centralized management monitoring
- Dashboard, statistical analysis, alarm notification, etc. IoT monitoring

# DASHBOARD for Wirerope

● Customizing Available

